



(New Holland/Earl Twp. Area)



# PUBLIC AUCTION

**3-BDRM 2.5-BATH 2-STORY 3,068 Sq. Ft. COLONIAL HOME \* .35-AC. LOT**  
**2-CAR GARAGE \* CUSTOM OAK KITCHEN \* FINISHED 1,000 Sq. Ft. BASEMENT**  
**2008 GMC ENVOY \* JD X300 MOWER \* POOL TABLE \* LAWN/GARDEN ITEMS**  
**NICE QUALITY FURNITURE \* ANTIQUES & PERSONAL PROPERTY**  
**SATURDAY, MAY 4, 2024 @ 9-AM/Real Estate @ NOON**



STUNNING CUSTOM 3-BR COLONIAL



3,068 SQ. FT. COLONIAL \* .35-AC. LOT



CUSTOM OAK CABINETRY KITCHEN

**Located at 472 Glen Mar Ave. New Holland, Pa. Earl Twp. Lancaster Co.**

**DIRECTIONS:** From Rt.23 Main St. New Holland take N. Railroad Ave ½ -mi. to left on Mar-Kauf Dr. to right on Glen Mar to home on left at cul-de-sac.

**REAL ESTATE:** Consists of a 3,068 sq. ft. 3-bdrm 2.5-bath 2-story brick & vinyl Colonial dwelling (1990) w/attached 2-car garage. Main floor features a tile foyer/staircase; 15'x17' custom Oak cabinetry 37-handle kitchen by S & N Woodworks, Newtown, Pa.; gas range; DW & fridge included; 11'x13' breakfast nook w/cathedral ceiling & skylights, patio door to 12'x36' covered back porch; 11'x9.5' laundry/mud room; attached 2-car garage; 14'x15.5' formal dining room w/HW flooring & wainscoting; powder room; 19'x13.5' formal living room w/HW floor; 22'x15' family room w/FP & bay window; upper level includes BR#1 19'x14' w/HW floor, WIC & 2-closets, 14'x12' private bath w/jet tub & shower; 2-15'x13' bedrooms w/closets & HW floors; 10'x10 full bath w/linen closet; 24'x22' attic storage; finished lower level features a 33'x13' TV/rec room; 21'x19' pool table room; 4th bedroom w/closet; 31'x12' utility room; 11'x15' mechanical room; Superior walls; 500-gallon LP tank; gas heat/central AC; on-site well & septic; annual taxes:\$4,891. Low maintenance brick & vinyl exterior, insulated windows; newer roof; private PVC fenced backyard w/playhouse; wide paved driveway.

**OPEN HOUSE: SAT. APRIL 13 & 20 from 1-3 PM for info call/text auctioneer @ (717) 371-3333.**

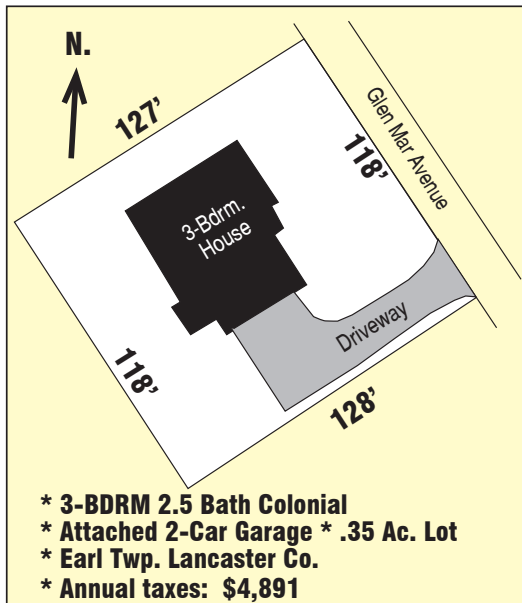

- \* 3-BDRM 2.5 Bath Colonial
- \* Attached 2-Car Garage \* .35 Ac. Lot
- \* Earl Twp. Lancaster Co.
- \* Annual taxes: \$4,891

**TERMS:** 10% down day of sale, balance in 60-days. Attorney: Patrick Deibler (717) 354-7700

**Note:** Outstanding custom-built move-in ready Colonial home on a quiet cul-de-sac setting just north of New Holland. Lots of valuable amenities throughout; inviting covered rear porch offers stunning farmland views & sunsets!

**FOR PHOTOS & COMPLETE LISTING VISIT [www.martinandrutt.com](http://www.martinandrutt.com)**

**VEHICLE:** 2008 GMC Envoy 4x4 SUV, black, automatic, runs good, 198k miles, recent inspection & service, VIN# 1GKDT135182134550.

**PERSONAL PROPERTY:** John Deere X300 riding mower; Snapper21" trim mower; Stihl FS40C trimmer; GE XLG washer; Bosch dryer; SS grill; hand & power tools; bedroom furniture by: Thomasville, Stanley & Pa. House; 2-king size beds & bedding; queen bed & bedding; 3-dressers; nice quilts, blankets & towels; Oak hutch & dining table w/6-chairs, server; 2-lighted curios; corner cupboard; round Oak table & 4-chairs; electric FP; 2-sofa & loveseat sets; marble hall rack & table; wooden rocker; coffee & end tables; Brunswick pool table & accessories; billiard clock; 3-sets of SS & Sterling flatware; Sterling tea set; new dinnerware set; pitcher & bowl set; hurricane lamp; 2-Johnny Unitas signed footballs; wicker sewing baskets; sewing machine; cedar chest; lots of quality clear glassware & figurines; antique dinnerware; lots of cookware & kitchen items; mantle clock; dolls & dollhouses w/furniture; child's toy kitchen; tricycles; 24-folding chairs; nice artwork prints & home décor; white wicker patio set; metal patio table & 4-chairs; porch swing; concrete birdbath & garden benches; decorative fountain; plus much more!

**TERMS:** Cash, PA check or credit card w/3% fee; sale held under tent bring a chair; good food provided!



2008 GMC ENVOY 198K ML.



JOHN DEERE X300 MOWER



NICE QUILTS & FURNISHINGS



COCA COLA ADVERTISING SIGN

**AUCTION BY:**  
**MARTIN & RUTT AUCTIONEERS**  
 Michael J. Martin (717) 371-3333  
 John J. Rutt II (717) 587-8906  
 Cameron J. Rutt



**AUCTION FOR:**  
**Raymond M. & Ruth A. Bowman**  
**(717) 278-5838**